

Hands on Happenings at Home

Roald Dahl's Imagination Seekers

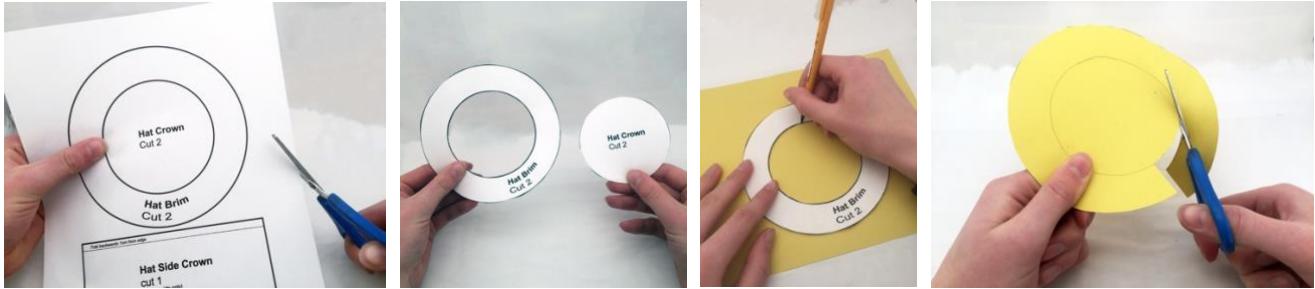

Make a Willy Wonka Sweet Hat



Print the hat template and cut it out. Trace and cut onto card – cereal packets are good for this.

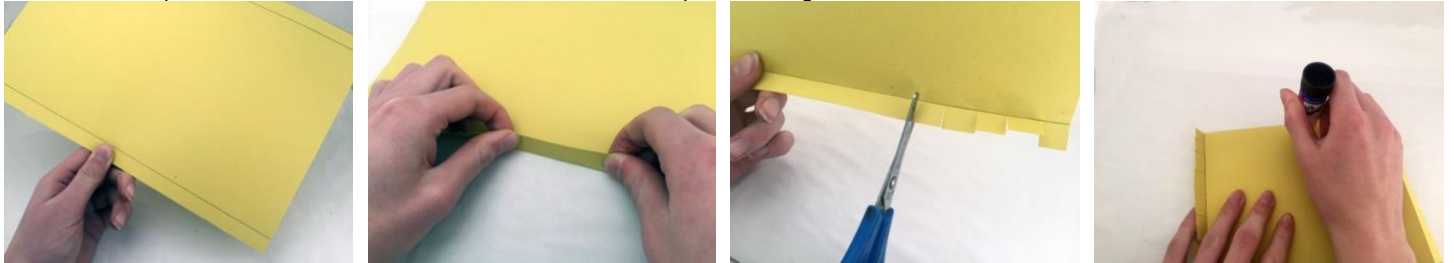

Use an A4 piece for the Hat Side Crown. Mark 1cm lines top and bottom, fold one forwards, the other backwards. Snip along folded edges. Glue edge.



Roll hat up and press together. Sellotape cut in brim

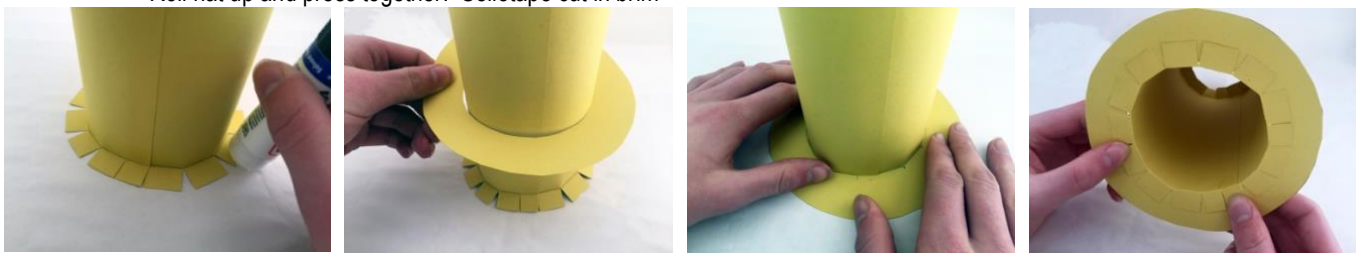

Glue folded out tabs on base of hat side then place one hat brim over it and press down to secure.



Put glue on second brim. Stick this onto hat to cover glued tabs. Glue top of hat and stick hat crown to it. Now DECORATE!

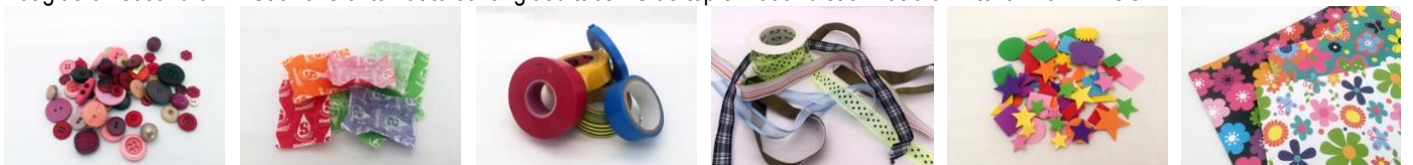

Some good things to decorate your hat with... buttons, sweet wrappers, tape, ribbons, foam shapes, wrapping paper. HAVE FUN!